

Desoutter



Industrial Tools



**LOUZAMPINI
& ASSOCIATES**

info@louzampini.com

www.louzampini.com

PHONE 1-800-353-4676

FAX 1-401-353-0113



Drilling Solutions

- *Straight drills*
- *Angle head drills*
- *Multi Drills*

More Than Productivity



Ergonomics...



Increase your productivity with the DR300 series...
The widest range of fixed-angle heads



How to select your tool:

- 1 Select material 2 Select hole size 3 Define speed

COMPACT HEAD

TOOL TYPE	FREE SPEED	STAINLESS STEEL	HARD CAST IRON MEDIUM HARD STEEL	SOFT CAST IRON MILD STEEL ①	HARD PLASTICS	ALUMINIUM BRASS, COPPER BRONZE	COMPOSITE	WOOD SOFT PLASTIC CHIPBOARD
	rpm	9-15m/min	10-20m/min	20-35m/min	30-40m/min	50-80m/min	50-100m/min	80-120m/min
FREE SPEEDS FROM 1000 TO 5500 RPM								
Drill Ømm (in.)								
DR300-T5/S5 (90°, 30° & 360° head)	5500	-	-	-	3.0 (1/8")	5.0 (3/16")	5.0 (3/16")	5.0 (3/16")
	4500	-	-	-	3.0 (1/8")	5.0 (3/16")	5.0 (3/16")	5.0 (3/16")
DR300-QR (90°, 30° & 360° head)	3000	③ -	-	3.0 (1/8") ②	5.0 (3/16")	5.0 (3/16")	5.0 (3/16")	-
	2000	3.0 (1/8")	4.0 (5/32")	5.0 (3/16")	-	-	-	-
	1000	4.0 (5/32")	5.0 (3/16")	-	-	-	-	-



LOUZAMPINI & ASSOCIATES
info@louzampini.com www.louzampini.com
PHONE 1-800-353-4676 FAX 1-401-353-0113

High productivity...

Drill anywhere with the DR300 Multi drills series
 Save time with fewer equipment changes.

Our multi-drill solution with its interchangeable, quick-release heads allow you to change the drill head and operating angle quickly increasing productivity.

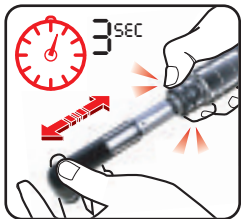

Quick-release head

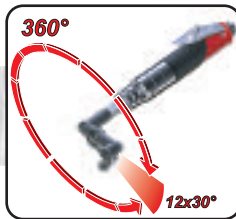

12 positions, 360° orientation



STANDARD HEAD

How to select your tool:

1 Select material 2 Select hole size 3 Define speed

TOOL TYPE	FREE SPEED	TITANIUM	STAINLESS STEEL	HARD CAST IRON MEDIUM HARD STEEL	SOFT CAST IRON MILD STEEL 1	HARD PLASTICS	ALUMINIUM BRASS, COPPER BRONZE	COMPOSITE	WOOD SOFT PLASTIC CHIPBOARD
	rpm	4.5m/min	9-15m/min	10-20m/min	20-35m/min	30-40m/min	50-80m/min	50-100m/min	80-120m/min
FREE SPEEDS FROM 550 TO 5500 RPM									
					Drill Ømm (in.)				
DR300-T6/S6 (90°, 45° & 360° head)	5500	-	-	-	-	3.0 (1/8")	6.0 (1/4")	5.0 (3/16")	6.5 (1/4")
	4500	-	-	-	-	3.0 (1/8")	6.0 (1/4")	5.0 (3/16")	6.5 (1/4")
	3000	3	-	-	-	3.0 (1/8") 2	5.0 (3/16")	6.5 (1/4")	6.5 (1/4")
DR300-QR (90°, 45° & 360° head)	2000	-	3.0 (1/8")	4.0 (5/32")	6.5 (1/4")	6.5 (1/4")	-	-	-
	1000	3.0 (1/8")	4.0 (5/32")	6.0 (1/4")	-	-	-	-	-
	550	6.0 (1/4")	6.5 (1/4")	6.5 (1/4")	-	-	-	-	-



LOUZAMPINI & ASSOCIATES
 info@louzampini.com
 PHONE 1-800-353-4676
 www.louzampini.com
 FAX 1-401-353-0113

Value For Money!

Feel the power in your hands ...
With the **DR300** straight body series

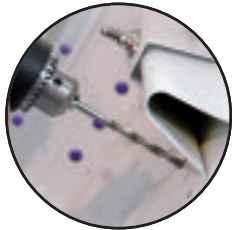

High precision
The DR300's high drive accuracy produces quality holes



Safety
Button or lever included for all DR300



High power
Efficient effective motor to maintain optimum drilling speed



Operator comfort
Excellent power-to-weight ratio gets the job done with minimum fatigue



LOUZAMPINI & ASSOCIATES
info@louzampini.com www.louzampini.com
PHONE 1-800-353-4676 FAX 1-401-353-0113

STRAIGHT DRILL

How to select your tool:

① Select material ② Select hole size ③ Define speed

TOOL TYPE	FREE SPEED	TITANIUM	STAINLESS STEEL	HARD CAST IRON MEDIUM HARD STEEL	SOFT CAST IRON MILD STEEL	HARD PLASTICS ①	ALUMINIUM BRASS. COPPER BRONZE	COMPOSITE	WOOD SOFT PLASTIC CHIPBOARD
	rpm	4.5m/min	9-15m/min	10-20m/min	20-35m/min	30-40m/min	50-80m/min	50-100m/min	80-120m/min
FREE SPEEDS FROM 550 TO 20000 RPM									
Drill Ømm (in.)									
DR300-T... 8-10 mm (5/16"-3/8") cap.	20000	-	-	-	-	-	-	4.0 (5/32")	2.0 (5/64")
	5500	-	-	-	-	-	4.0 (5/32")	5.0 (3/16")	6.0 (1/4")
	4500	③ -	-	-	-	3.0 (1/8") ②	6.0 (1/4")	-	8.0 (5/16")
	3000	-	-	-	4.0 (5/32")	5.0 (3/16")	8.0 (5/16")	-	-
	2000	-	3.0 (1/8")	4.0 (5/32")	6.0 (1/4")	8.0 (5/16")	-	-	-
	1000	3.0 (1/8")	4.0 (5/32")	6.0 (1/4")	8.0 (5/16")	-	-	-	-
	550	6.0 (1/4")	8.0 (5/16")	-	-	-	-	-	-





LOUZAMPINI & ASSOCIATES

info@louzampini.com
PHONE 1-800-353-4676

www.louzampini.com
FAX 1-401-353-0113





LOUZAMPINI & ASSOCIATES

info@louzampini.com
PHONE 1-800-353-4676

www.louzampini.com
FAX 1-401-353-0113

TECHNICAL DATA

MODEL	PART NUMBER	FREE SPEED	MOTOR POWER		WEIGHT	
			rpm	Kw	hp	kg

COMPACT 90° ANGLE HEAD

COLLET SPINDLE - 5mm (3/16") CAPACITY

DR300-T5500-T5-90	205 147 551 4	5500	0.3	0.4	0.62	1.36
DR300-T4500-T5-90	205 147 549 4	4500	0.3	0.4	0.62	1.36
DR300-T3000-T5-90	205 147 547 4	3000	0.3	0.4	0.62	1.36
DR300-T2000-T5-90	205 147 545 4	2000	0.3	0.4	0.62	1.36
DR300-T1000-T5-90	205 147 543 4	1000	0.3	0.4	0.70	1.54

1/4" x 28 SPINDLE - 5mm (3/16") CAPACITY

DR300-T5500-S5-90	205 147 552 4	5500	0.3	0.4	0.62	1.36
DR300-T4500-S5-90	205 147 550 4	4500	0.3	0.4	0.62	1.36
DR300-T3000-S5-90	205 147 548 4	3000	0.3	0.4	0.62	1.36
DR300-T2000-S5-90	205 147 546 4	2000	0.3	0.4	0.62	1.36
DR300-T1000-S5-90	205 147 544 4	1000	0.3	0.4	0.70	1.54

COMPACT 30° ANGLE HEAD

COLLET SPINDLE - 5mm (3/16") CAPACITY

DR300-T5500-T5-30	205 147 539 4	5500	0.3	0.4	0.62	1.36
DR300-T4500-T5-30	205 147 537 4	4500	0.3	0.4	0.62	1.36
DR300-T3000-T5-30	205 147 535 4	3000	0.3	0.4	0.62	1.36
DR300-T2000-T5-30	205 147 533 4	2000	0.3	0.4	0.62	1.36
DR300-T1000-T5-30	205 147 531 4	1000	0.3	0.4	0.70	1.54

1/4" x 28 SPINDLE - 5mm (3/16") CAPACITY

DR300-T5500-S5-30	205 147 540 4	5500	0.3	0.4	0.62	1.36
DR300-T4500-S5-30	205 147 538 4	4500	0.3	0.4	0.62	1.36
DR300-T3000-S5-30	205 147 536 4	3000	0.3	0.4	0.62	1.36
DR300-T2000-S5-30	205 147 534 4	2000	0.3	0.4	0.62	1.36
DR300-T1000-S5-30	205 147 532 4	1000	0.3	0.4	0.70	1.54

COMPACT 360° ANGLE HEAD

COLLET SPINDLE - 5mm (3/16") CAPACITY

DR300-T5500-T5-360	205 147 563 4	5500	0.3	0.4	0.70	1.54
DR300-T4500-T5-360	205 147 561 4	4500	0.3	0.4	0.70	1.54
DR300-T3000-T5-360	205 147 559 4	3000	0.3	0.4	0.70	1.54
DR300-T2000-T5-360	205 147 557 4	2000	0.3	0.4	0.70	1.54
DR300-T1000-T5-360	205 147 555 4	1000	0.3	0.4	0.78	1.72

1/4" x 28 SPINDLE - 5mm (3/16") CAPACITY

DR300-T5500-S5-360	205 147 564 4	5500	0.3	0.4	0.70	1.54
DR300-T4500-S5-360	205 147 562 4	4500	0.3	0.4	0.70	1.54
DR300-T3000-S5-360	205 147 560 4	3000	0.3	0.4	0.70	1.54
DR300-T2000-S5-360	205 147 558 4	2000	0.3	0.4	0.70	1.54
DR300-T1000-S5-360	205 147 556 4	1000	0.3	0.4	0.78	1.72

MULTI DRILLS

DR350-P3000-QR	205 147 528 4	3000	0.3	0.4	0.50	1.10
DR300-T5500-QR	205 147 527 4	5500	0.3	0.4	0.50	1.10
DR300-T4500-QR	205 147 526 4	4500	0.3	0.4	0.50	1.10
DR300-T3000-QR	205 147 525 4	3000	0.3	0.4	0.50	1.10
DR300-T2000-QR	205 147 524 4	2000	0.3	0.4	0.50	1.10
DR300-T1000-QR	205 147 523 4	1000	0.3	0.4	0.58	1.27
DR300-T550-QR	205 147 522 4	550	0.3	0.4	0.58	1.27

ANGLE HEADS

205 050 331 3	Compact 90° Angle Head - Collet spindle	5.0	3/16
205 050 332 3	Compact 90° Angle Head - 1/4" x 28 spindle		
205 050 329 3	Compact 30° Angle Head - Collet spindle	5.0	3/16
205 050 330 3	Compact 30° Angle Head - 1/4" x 28 spindle		
205 050 333 3	Compact 360° Angle Head - Collet spindle	5.0	3/16
205 050 334 3	Compact 360° Angle Head - 1/4" x 28 spindle		
205 050 338 3	Standard 90° Angle Head - Collet spindle	6.4	1/4
205 050 353 3	Standard 90° Angle Head - Collet spindle	8.0	5/16
205 050 339 3	Standard 90° Angle Head - 1/4" x 28 spindle		
205 050 340 3	Standard 90° Angle Head - 5/16" x 24 spindle		
205 050 341 3	Standard 360° Angle Head - Collet spindle	6.4	1/4
205 050 342 3	Standard 360° Angle Head - 1/4" x 28 spindle		
205 050 343 3	Standard 360° Angle Head - 5/16" x 24 spindle		
205 050 335 3	Standard 45° Angle Head - Collet spindle	6.4	1/4
205 050 336 3	Standard 45° Angle Head - 1/4" x 28 spindle		
205 050 337 3	Standard 45° Angle Head - 5/16" x 24 spindle		
205 050 543 3	Chuck mounting 3/8" x 24 tpi		

Please refer to
our Accessories catalogue
PN 615 993 539 8

Air line Network





MODEL	PART NUMBER	FREE SPEED	MOTOR POWER		WEIGHT	
			rpm	Kw	hp	kg

STANDARD 90° ANGLE HEAD

COLLET SPINDLE - 6.4mm (1/4") CAPACITY

DR300-T5500-T6-90	205 147 598 4	5500	0.3	0.4	0.68	1.49
DR300-T4500-T6-90	205 147 595 4	4500	0.3	0.4	0.68	1.49
DR300-T3000-T6-90	205 147 592 4	3000	0.3	0.4	0.68	1.49
DR300-T2000-T6-90	205 147 589 4	2000	0.3	0.4	0.68	1.49
DR300-T1000-T6-90	205 147 586 4	1000	0.3	0.4	0.76	1.67
DR300-T550-T6-90	205 147 583 4	550	0.3	0.4	0.76	1.67

1/4" x 28 SPINDLE - 6.4mm (1/4") CAPACITY

DR300-T5500-S6-90	205 147 599 4	5500	0.3	0.4	0.68	1.49
DR300-T4500-S6-90	205 147 596 4	4500	0.3	0.4	0.68	1.49
DR300-T3000-S6-90	205 147 593 4	3000	0.3	0.4	0.68	1.49
DR300-T2000-S6-90	205 147 590 4	2000	0.3	0.4	0.68	1.49
DR300-T1000-S6-90	205 147 587 4	1000	0.3	0.4	0.76	1.67
DR300-T550-S6-90	205 147 584 4	550	0.3	0.4	0.76	1.67

STANDARD 45° ANGLE HEAD

COLLET SPINDLE - 6.4mm (1/4") CAPACITY

DR300-T5500-T6-45	205 147 580 4	5500	0.3	0.4	0.68	1.49
DR300-T4500-T6-45	205 147 577 4	4500	0.3	0.4	0.68	1.49
DR300-T3000-T6-45	205 147 574 4	3000	0.3	0.4	0.68	1.49
DR300-T2000-T6-45	205 147 571 4	2000	0.3	0.4	0.68	1.49
DR300-T1000-T6-45	205 147 568 4	1000	0.3	0.4	0.68	1.49
DR300-T550-T6-45	205 147 565 4	550	0.3	0.4	0.68	1.49

1/4" x 28 SPINDLE - 6.4mm (1/4") CAPACITY

DR300-T5500-S6-45	205 147 581 4	5500	0.3	0.4	0.68	1.49
DR300-T4500-S6-45	205 147 578 4	4500	0.3	0.4	0.68	1.49
DR300-T3000-S6-45	205 147 575 4	3000	0.3	0.4	0.68	1.49
DR300-T2000-S6-45	205 147 572 4	2000	0.3	0.4	0.68	1.49
DR300-T1000-S6-45	205 147 569 4	1000	0.3	0.4	0.68	1.49
DR300-T550-S6-45	205 147 566 4	550	0.3	0.4	0.68	1.49

STANDARD 360° ANGLE HEAD

COLLET SPINDLE - 6.4mm (1/4") CAPACITY

DR300-T5500-T6-360	205 147 616 4	5500	0.3	0.4	0.85	1.87
DR300-T4500-T6-360	205 147 613 4	4500	0.3	0.4	0.85	1.87
DR300-T3000-T6-360	205 147 610 4	3000	0.3	0.4	0.77	1.69
DR300-T2000-T6-360	205 147 607 4	2000	0.3	0.4	0.77	1.69
DR300-T1000-T6-360	205 147 604 4	1000	0.3	0.4	0.85	1.87
DR300-T550-T6-360	205 147 601 4	550	0.3	0.4	0.85	1.87

1/4" x 28 SPINDLE - 6.4mm (1/4") CAPACITY

DR300-T5500-S6-360	205 147 617 4	5500	0.3	0.4	0.77	1.69
DR300-T4500-S6-360	205 147 614 4	4500	0.3	0.4	0.77	1.69
DR300-T3000-S6-360	205 147 611 4	3000	0.3	0.4	0.77	1.69
DR300-T2000-S6-360	205 147 608 4	2000	0.3	0.4	0.77	1.69
DR300-T1000-S6-360	205 147 605 4	1000	0.3	0.4	0.85	1.87
DR300-T550-S6-360	205 147 602 4	550	0.3	0.4	0.85	1.87

STRAIGHT GRIP DRILLS

KEY CHUCK MODELS

DR300-T20000-C8	205 147 496 4	20000	0.3	0.4	0.47	1.03
DR300-T5500-C8	205 147 493 4	5500	0.3	0.4	0.60	1.32
DR300-T4500-C8	205 147 490 4	4500	0.3	0.4	0.60	1.32
DR300-T3000-C8	205 147 487 4	3000	0.3	0.4	0.60	1.32
DR300-T2000-C8	205 147 484 4	2000	0.3	0.4	0.60	1.32
DR300-T1000-C10	205 147 481 4	1000	0.3	0.4	0.75	1.65
DR300-T550-C10	205 147 478 4	550	0.3	0.4	0.75	1.65

WITHOUT CHUCK MODELS

DR300-T20000*	205 147 495 4	20000	0.3	0.4	0.34	0.75
DR300-T5500*	205 147 492 4	5500	0.3	0.4	0.47	1.04
DR300-T4500*	205 147 489 4	4500	0.3	0.4	0.47	1.04
DR300-T3000*	205 147 486 4	3000	0.3	0.4	0.47	1.04
DR300-T2000*	205 147 483 4	2000	0.3	0.4	0.47	1.04
DR300-T1000*	205 147 480 4	1000	0.3	0.4	0.52	1.15
DR300-T550*	205 147 477 4	550	0.3	0.4	0.52	1.15

* Chuck spindle 3/8"x24 UNC

>THE WIDEST RANGE OF STRAIGHT AND ANGLE HEAD DRILLS

Desoutter pneumatic tools are designed to provide operator safety and high productivity for all your drilling tasks, thanks to our wide range of straight and angle-head drills.

>POWER

The power of the DR300 series is ideal for drilling applications such as aluminium, steel, wood and composites.

Available with seven free speeds, from 550 to 20 000 rpm, we have the right drill for your application.

>ERGONOMY

Based on our expertise and customer feedback, Desoutter engineers have developed a range of compact and powerful drills that provide maximum comfort during operations.

>INNOVATION

By offering fixed and interchangeable heads, the DR300 series continues Desoutter's long tradition of innovation in pneumatic tools.

