

Auto Feed Drills and Tappers Multi Head Mounting

Lou Zampini & Associates 37 Conifer Drive, North Providence, RI 02904 1 401 354 8878 FAX 1 401 353 0113
<http://www.DesoutterTools.com>

Fitting a Multi Head to AFD(E) 41 or 400 or 600 series or AFT(E) 470/480 Series

Basic Layout:

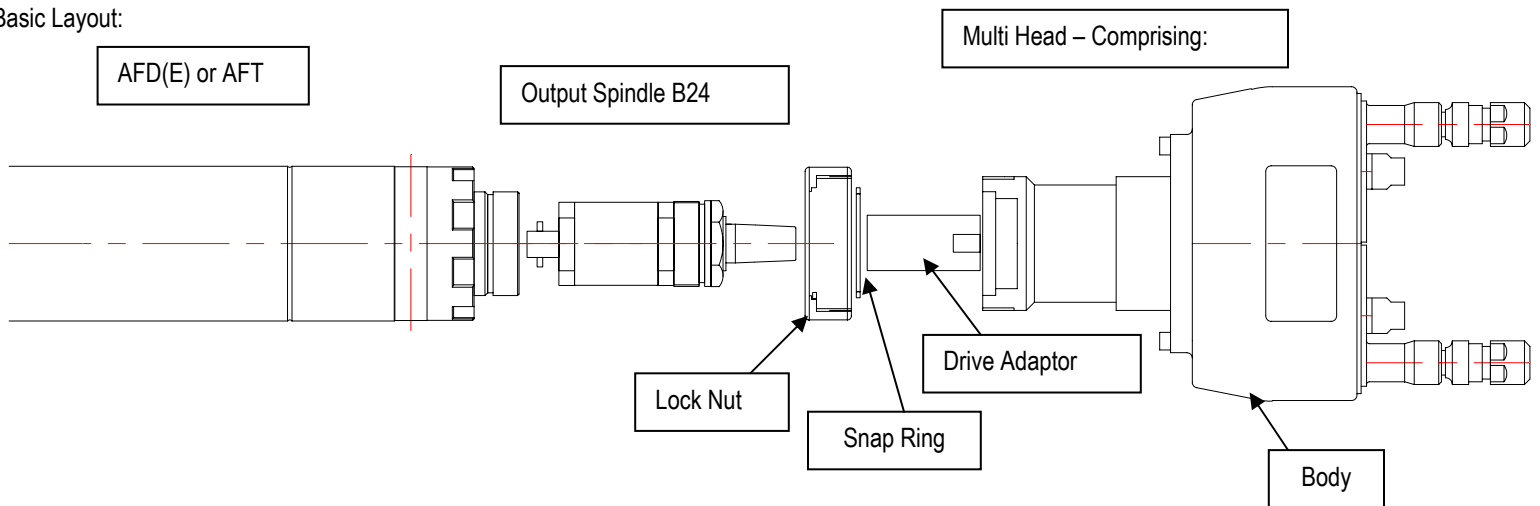

Step One: Fit B24 Output Spindle

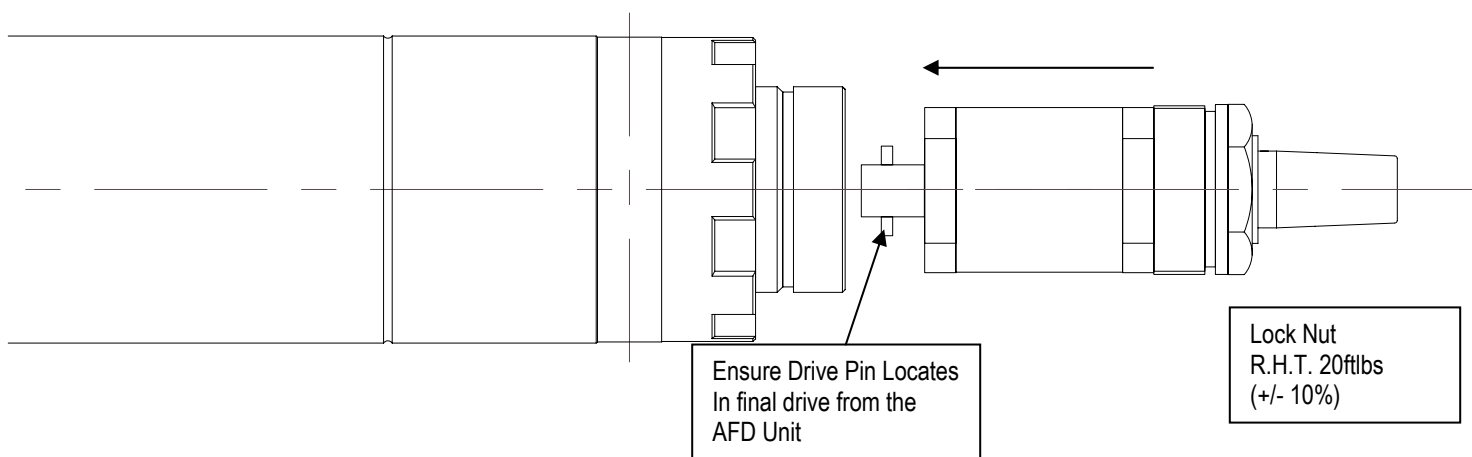

Step Two Fit Lock Nut and Snap Ring – From Multiple Spindle Assembly

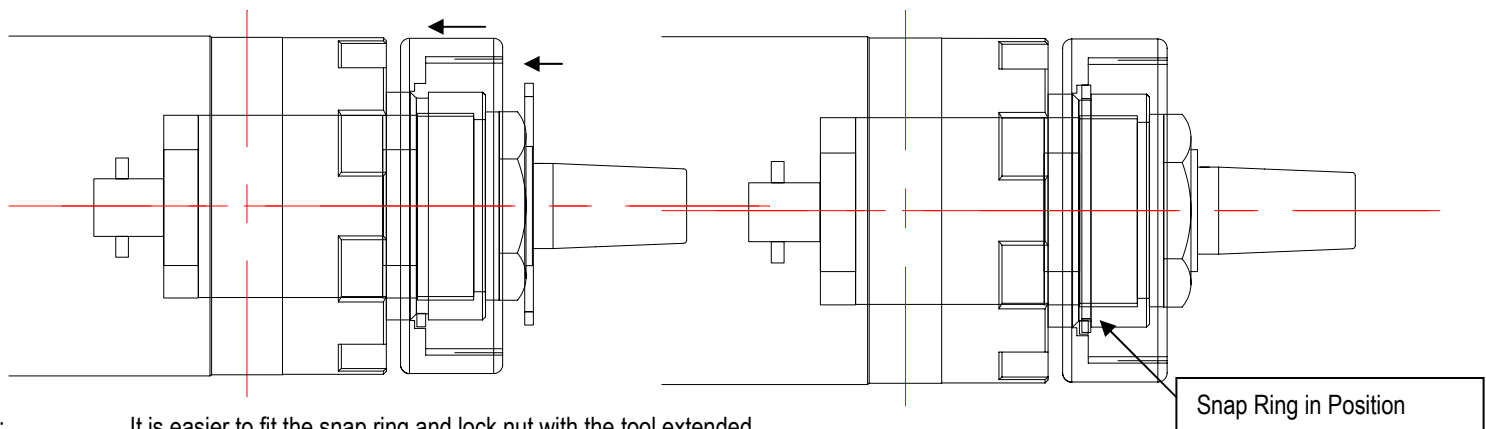

NOTE: It is easier to fit the snap ring and lock nut with the tool extended. This can be done with two people, one holding the tool forward against the spring return while the other fits the multi-head.

Auto Feed Drills and Tappers **Multi Head Mounting**

Lou Zampini & Associates 37 Conifer Drive, North Providence, RI 02904 1 401 354 8878 FAX 1 401 353 0113
<http://www.DesoutterTools.com>

Step Three Fit the Drive Adaptor

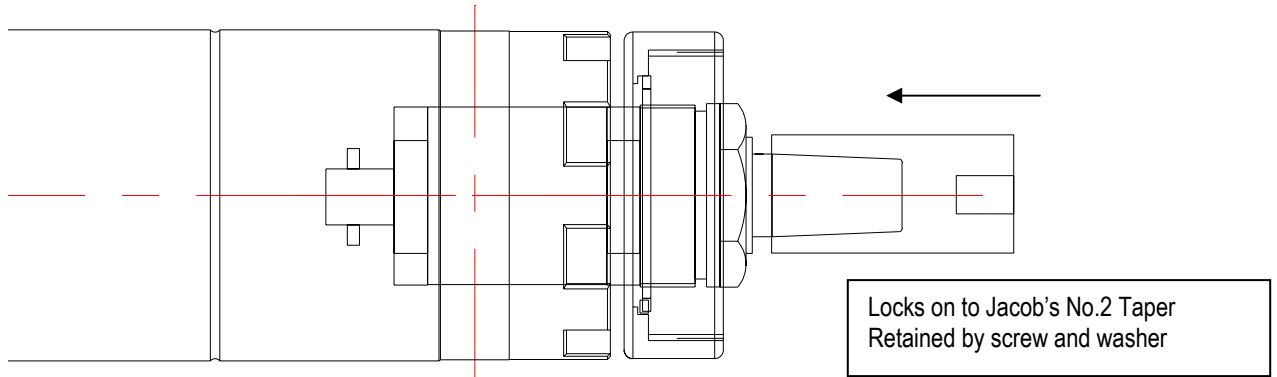

Step Four Attach the Multi Head Body

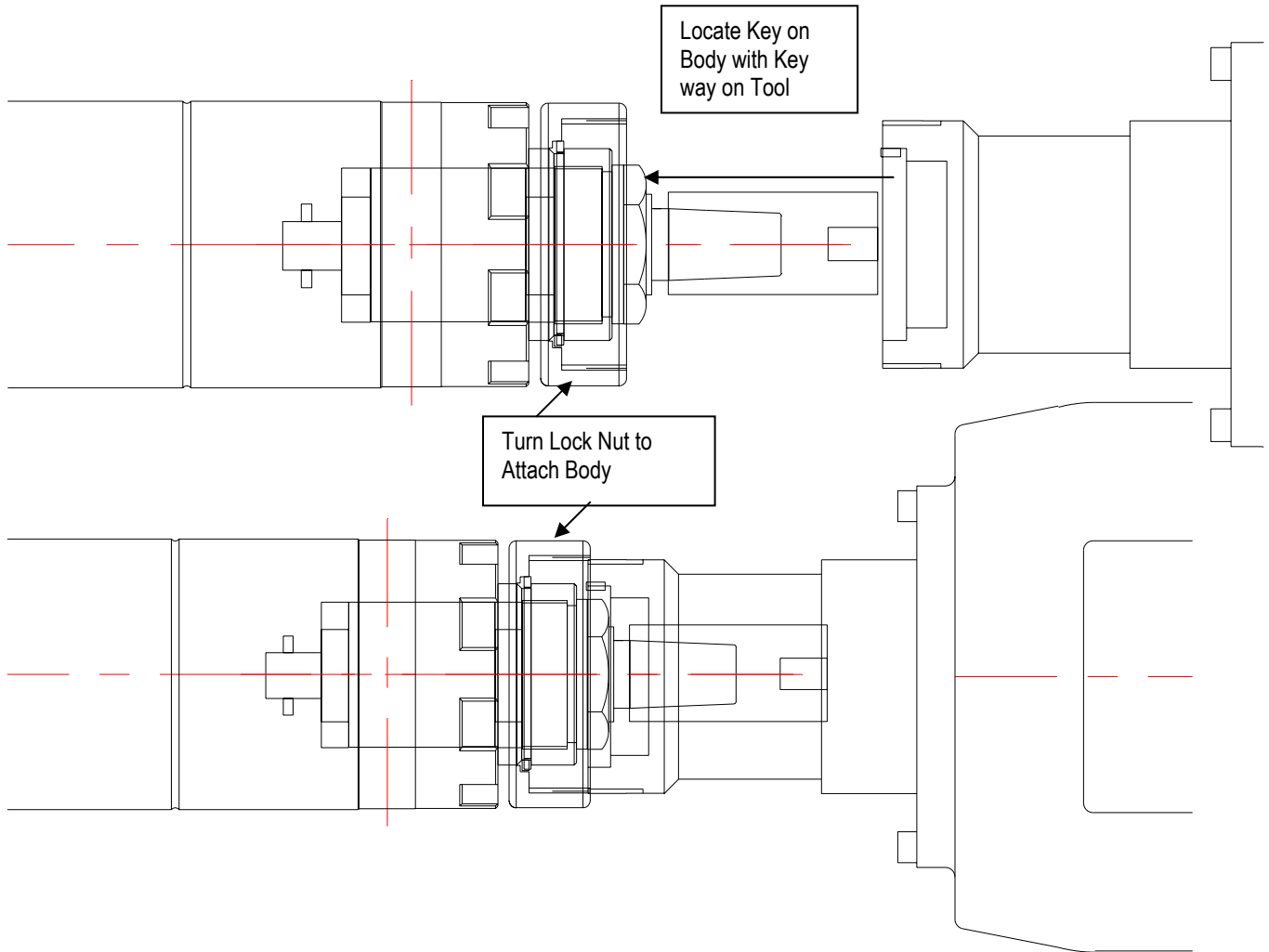

Auto Feed Drills and Tappers **Multi Head Mounting**

Lou Zampini & Associates 37 Conifer Drive, North Providence, RI 02904 1 401 354 8878 FAX 1 401 353 0113
<http://www.DesoutterTools.com>

Ensure Drive Adaptor Locates In the Drive to the Spindles – Rotate the Spindles To Engage if Necessary

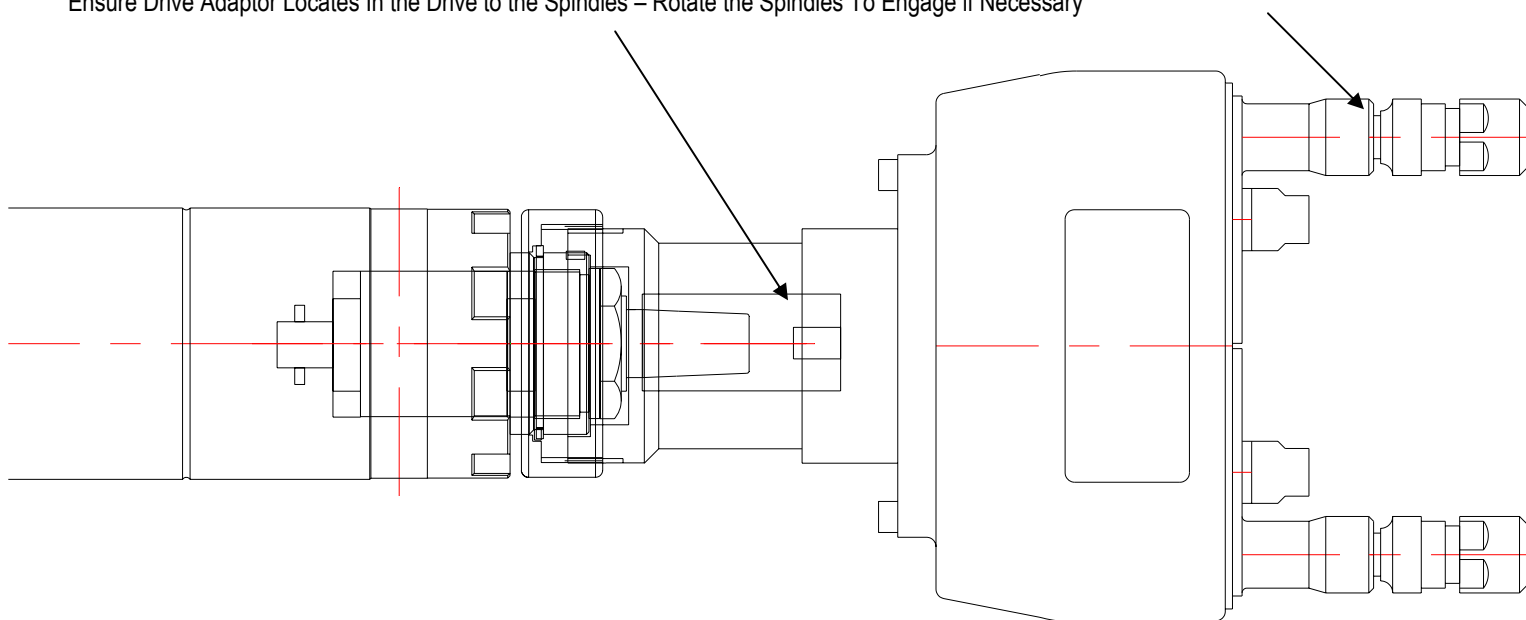

Auto Feed Drills and Tappers Multi Head Mounting

Lou Zampini & Associates 37 Conifer Drive, North Providence, RI 02904 1 401 354 8878 FAX 1 401 353 0113
<http://www.DesoutterTools.com>

Some multiheads allow the spindle body to be rotated independently of the mounting adaptor through bolts on the head face. If the head does not allow this then to Re-Orientate the Head Relative to the drill unit use the HCU Mounting Bracket – Also for Stroke Adjustment

