

Desoutter



Desoutter Limited, London NW9 6ND

RollerTork Clutch

(GB) Servicing Instructions
 Parts List
 Operating Instructions

(D) Wartungsanleitung
 Teileliste
 Bedienungsanleitung

(F) Manuel d'entretien
 Liste de pièces
 Manuel d'utilisation

(E) Instrucciones de Servicio
 Listas de Repuestos
 Instrucciones de Operación

(P) Instruções de Manutenção
 Listas de Peças
 Instruções de Funcionamento

(I) Istruzioni per la Manutenzione
 Elenco delle Parti
 Istruzioni Operative

(GR) Οδηγίες Συντήρησης
 Κατάλογοι Ανταλλακτικών
 Οδηγίες Λειτουργίας

(NL) Onderhoudsinstructies
 Onderdelenlijst
 Bedieningsinstructies

(DK) Servicevejledning
 Liste over dele
 Betjeningsvejledning

(N) Serviceinstruksjoner
 Deleliste
 Driftsinstruksjoner

(S) Serviceinstruktioner
 Reservdelislista
 Bruksanvisning

(FIN) Huolto-ohjeet
 Osaluettelo
 Käyttöohjeet

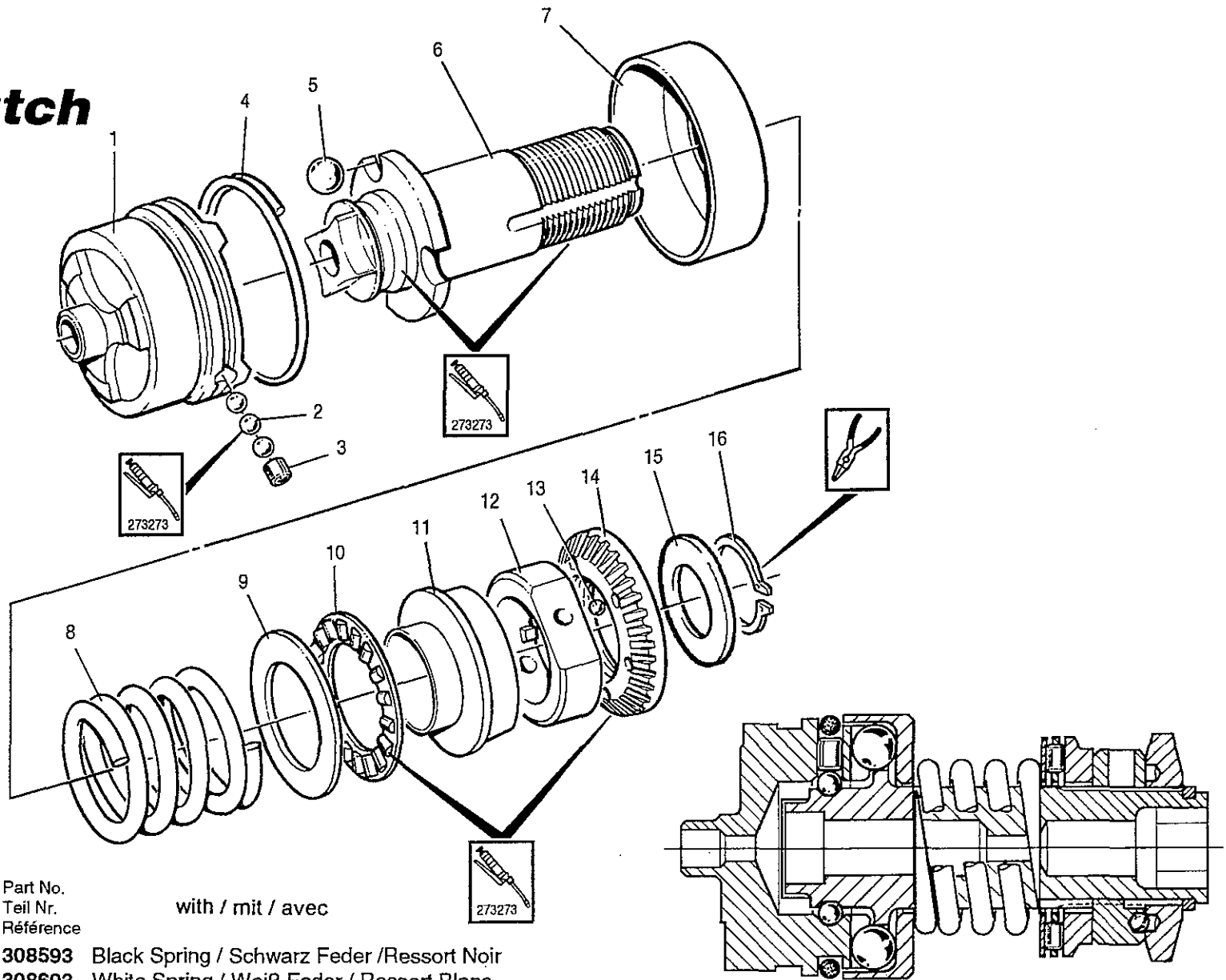

Part No.
 Teil Nr.
 Référence

with / mit / avec

308593 Black Spring / Schwarz Feder / Ressort Noir
 308603 White Spring / Weiß Feder / Ressort Blanc
 308613 Natural Spring / Naturfarbene Feder / Ressort Neutre

PARTS LIST

Item	Part No	Qty
1	310103	1
2	72228	14
3	301283	1
4	84063	1
5	66868	4
6	301173	1
7	354313	1
8	179133(B)	1
	(308593)	
	179923 (W)	1
	(308603)	
	304853(N)	1
	(308613)	
9	301313	1
10	301303	1
11	301213	1
12	301233	1
13	72408	3
14	301223	1
15	203943	1
16	42353	1

INTRODUCTION

Before commencing work make sure that the fault is clutch related and not in the tool itself. Also that spare parts are to hand.

TO DISMANTLE

NOTE: Check Fault Finding Section before dismantling clutch.

Stand the clutch upright, on the work bench, with the adjustment end at the top. Using the illustration as a guide, carefully dismantle the tool.

TO ASSEMBLE:

NOTE: Use BP Q5618 grease where indicated.

Grease the ball tracks in clutch cam (1) and spindle (6). Bring together and feed the fourteen balls (2) into their tracking. Insert roller (3) after the last ball.

Apply grease to each slot and locate the balls (5x4) followed by the ball cup (7)

FAULT FINDING

Fault

1. Tool starts immediately air is applied (push start tools only).
2. Tool fails to start or runs too slowly.
3. Tool ratchets.
4. Tool works once but fails to reset.
5. Tools shut off but without disengaging drive, causing excessive operator reaction.

Possible Cause

- Protrusion of push-rod from tool too long.
- Protrusion of push-rod from tool too short.
- Protrusion of push-rod from tool too long, (pistol-grip and lever start tools only).
Push-rod jammed.
- Protrusion of push-rod from tool too long. Latch pin jamming.
Clutch push-rod jamming in spindle.
Clutch push-rod not retracting completely into spindle.
- Clutch spring over compressed.

©Copyright 1994, Desoutter, London NW9 6ND, UK.

All rights reserved. Any unauthorized use or copying of the contents or part thereof is prohibited. This applies in particular to trademarks, model denominations, part numbers and drawings. Use only authorized parts. Any damage or malfunction caused by the use of unauthorized parts is not covered by Warranty or Product Liability.

