

Desoutter

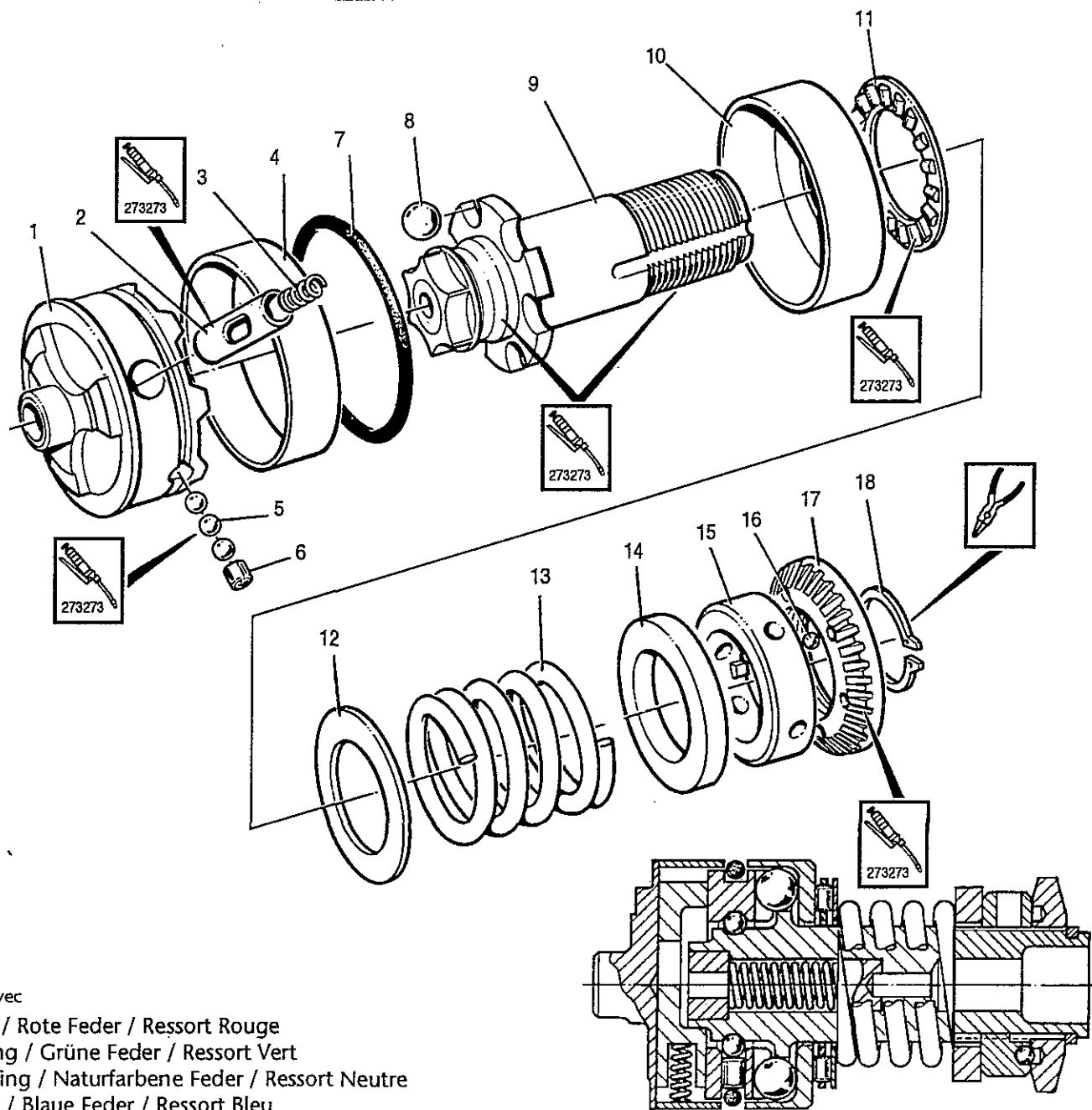

Desoutter Limited. HP2 7DR.UK

"Target Tork" Clutch



(GB) Servicing Instructions
Parts List
Operating Instructions

(D) Wartungsanleitung
Teilleiste
Bedienungsanleitung

(F) Manuel d'entretien
Liste de pièces
Manuel d'utilisation

(E) Instrucciones de Servicio
Listas de Repuestos
Instrucciones de Operación

(P) Instruções de Manutenção
Listas de Peças
Instruções de Funcionamento

(I) Istruzioni per la Manutenzione
Elenco delle Parti
Istruzioni Operative

(GR) Οδηγίες Συντήρησης
Κατάλογοι Ανταλλαχτών
Οδηγίες Λειτουργίας

(NL) Onderhoudsinstructies
Onderdelenlijst
Bedieningsinstructies

(DK) Servicevejledning
Liste over dele
Betjeningsvejledning

(N) Serviceinstruksjoner
Deleliste
Driftsinstruksjoner

(S) Serviceinstruktioner
Reservdelistsa
Bruksanvisning

(FIN) Huolto-ohjeet
Osaluettelo
Käyttöohjeet

Part No.	With / Mit / Avec
389803	Red Spring / Rote Feder / Ressort Rouge
389813	Green Spring / Grüne Feder / Ressort Vert
389793	Natural Spring / Naturfarbene Feder / Ressort Neutre
389823	Blue Spring / Blaue Feder / Ressort Bleu



Item	Part No	Qty
1	296693	1
2	296623	1
3	307123	1
4	296683	1
5	72408	14
6	18243	1
7	37233	1
8	81243	6
9	296983	1
	(389803)	
	(389813)	
	(389823)	
9	296993	1
	(389793)	
10	296673	1
11	297963	1
12	297973	1
13	67428 (R)	1
	(389803)	
13	68448 (G)	1
	(389813)	
13	73318 (B)	1
	(389823)	
13	251923 (N)	1
	(389793)	
14	389833	1
15	76013	1
16	72228	3
17	76003	1
	(389803)	
	(389813)	
	(389823)	
17	275563	1
	(389793)	
18	218453	1

INTRODUCTION

Before commencing work make sure that the fault is clutch related and not in the tool itself. Also that spare parts are to hand.

TO DISMANTLE

NOTE: Check Fault Finding Section before dismantling clutch. Stand the clutch upright, on the work bench, with the adjustment end at the top. Using the illustration as a guide, carefully dismantle the tool.

TO ASSEMBLE:

NOTE: Use BP Q5618 grease where indicated. Grease the ball tracks in clutch cam (1) and spindle (9). Bring together and feed the fourteen balls (5) into their tracking. Insert roller (6) after the last ball. Locate spring (3) in the latch pin hole, fit retaining sleeve (4) followed by 'O'ring (7). Apply grease to each slot and locate the six balls (8) followed by the ball cup (10)

LUBRICATION

273273 = BP Q5618

Lou Zampini & Associates

2 Douglas Pike, Rt. 7
 Smithfield, RI 02917
 1 800 353 4676
 FAX 1 401 679 0165

FAULT FINDING

Fault

1. Tool starts immediately power is applied (push start tools only).
2. Tool fails to start or runs too slowly.
3. Tool ratchets.
4. Tool works once but fails to reset.
5. Tools shut off but without disengaging drive, causing excessive operator reaction.

Possible Cause

- Protrusion of push-rod from tool too long.
- Protrusion of push-rod from tool too short.
- Protrusion of push-rod from tool too long, (pistol-grip and lever start tools only).
 Push-rod jammed.
- Protrusion of push-rod from tool too long. Latch pin jamming.
 Clutch push-rod jamming in spindle.
 Clutch push-rod not retracting completely into spindle.
- Clutch spring over compressed.

© Copyright 1998, Desoutter Limited. HP2 7DR. UK
 All rights reserved. Any unauthorized use or copying of the contents or part thereof is prohibited. This applies in particular to trademarks, model denominations, part numbers and drawings.
 Use only authorized parts. Any damage or malfunction caused by the use of unauthorized parts is not covered by Warranty or Product Liability.