

Tappers

Lou Zampini & Associates
 2 Douglas Pike
 Smithfield, RI 02917
 401 354 8878 , 1800 353 4676
 FAX 401 353 0113
<http://www.LouZampini.com>
<http://www.PneumaticToolsOnline.com>



A



B



C



D

Accessories: see page 260

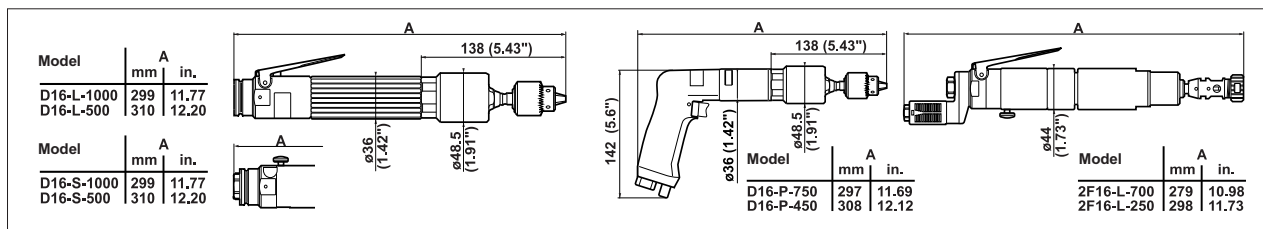

PIC REF	MODEL	PART NUMBER	FREE SPEED	REVERSE SPEED	CHUCK SIZE		MAX. TAPPING TORQUE		WEIGHT		AIR FLOW		AIR INLET	HOSE INT. Ø	
			rpm	rpm	mm	in.	Nm	ft.lb	kg	lb	l/s	cfm	BSP/NPT	mm	in.

D SERIES

Button Start – push/pull reverse

A	D16-S-1000	1274544	1000	2000	6.5	1/4	4.3	3.17	1.3	2.86	9.4	19.9	1/4"	10	3/8
A	D16-S-500	1274384	500	1000	10.0	3/8	8.6	6.34	1.4	3.08	9.4	19.9	1/4"	10	3/8

Lever Start – push/pull reverse

B	D16-L-1000	1274624	1000	2000	6.5	1/4	4.3	3.17	1.3	2.86	9.4	19.9	1/4"	10	3/8
B	D16-L-500	1274464	500	1000	10.0	3/8	8.6	6.34	1.4	3.08	9.4	19.9	1/4"	10	3/8

Trigger Start – push/pull reverse

C	D16-P-750	1288084	750	1500	6.5	1/4	6.2	4.57	1.7	3.75	8.5	18.0	1/4"	10	3/8
C	D16-P-450	1287934	450	900	10.0	3/8	11.1	8.18	1.8	3.97	8.5	18.0	1/4"	10	3/8

F SERIES

Lever Start – button reverse – stand mounted

D	2F16-L-700	1241394	700	700	6.5	1/4	6.7	4.94	1.7	3.75	11.1	23.5	1/4"	10	3/8
D	2F16-L-250	1241474	250	250	6.5	1/4	17.5	12.90	1.8	3.97	11.1	23.5	1/4"	10	3/8

